

Customer drawings

NOTE:

MATERIAL:

1. TERMINAL: COPPER ALLOY
2. HOUSING: HIGH TEMPERATURE THERMOPLASTIC
GLASS FILLED UL 94V-0. COLOR: BLACK

PLATED:

1. CONTACT AREA : PLATING GOLD OVER 0.38 MICROMETERS NICKEL.
2. SURFACE MOUNT CONTACT: 1.25~2.54 MICROMETERS MATTE TIN
OVER 1.25~2.54 MICROMETERS NICKEL.

MECHANICAL REQUIREMENT:

1. DURABILITY: 100 CYCLES MIN.
2. INSERTION AND EXTRACTION FORCE: 40N MAX & 11.5N MAX

ENVIRONMENTAL:

1. CONTACT RESISTANCE: 20 MILLIOHMS MAX INITIAL.
2. DIELECTRIC WITHSTANDING VOLTAGE: 700V AC/MIN.
3. OPERATION: -40°C~+85°C.
4. STORAGE: -55°C~+105°C.
5. WAVE SOLDERING TEMPERATURE: 255~265°C (5~10 SECONDS).
6. ROHS COMPLIANT

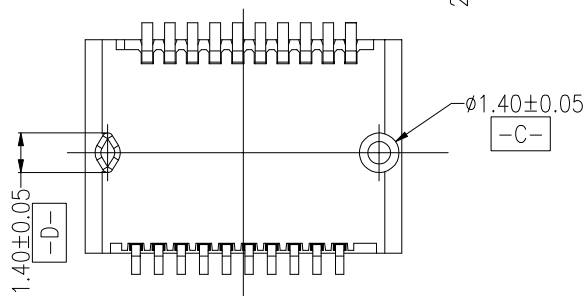
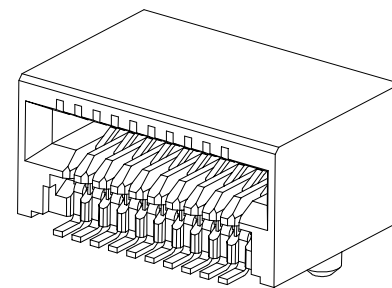
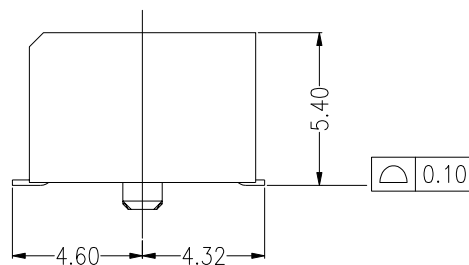
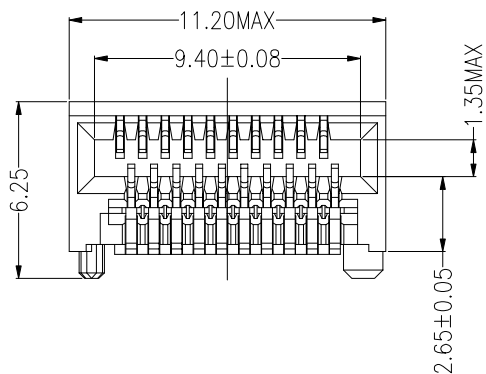
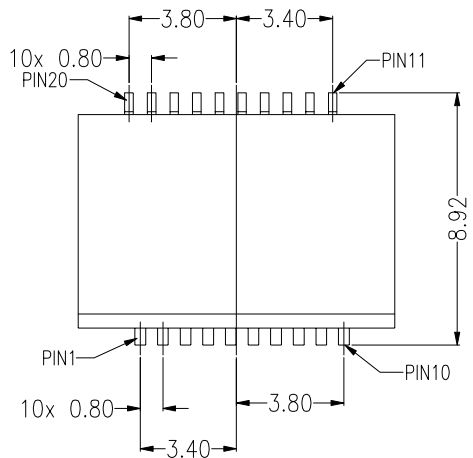

自由公差		设计	2015.04.09	苏州沃虎电子科技有限公司				
长度尺寸	角度尺寸			Shmily	SUZHOU WOHU ELECTRONIC TECHNOLOGY CO.,LTD			
x. ±0.30	x' ±0.5°	审核	GZW	2015.04.09	品名	SFP 1x1 CONNECTOR		
.x ±0.30	.x' ±0.5°				料号	81-151-40001-1		
.xx ±0.20	.xx' ±0.5°				图号	ESFP15020325-C		
.xxx ±0.10	.xxx' ±0.5°							
单位	mm	比例	1:1	核准	Neil	2015.04.09	版本	A
A4	⊕	页次	1 of 2					

Customer drawings

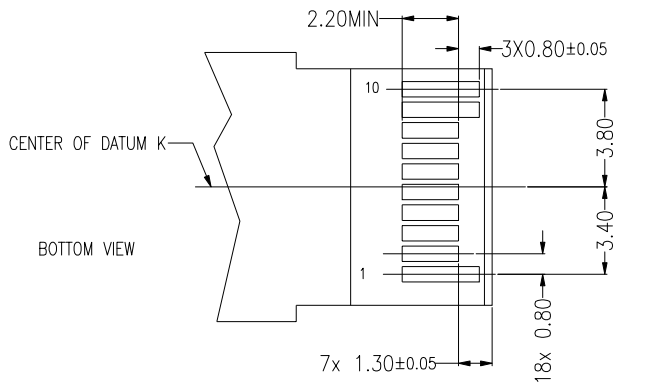
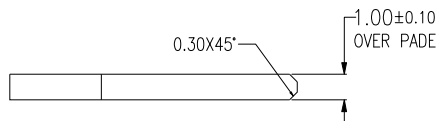
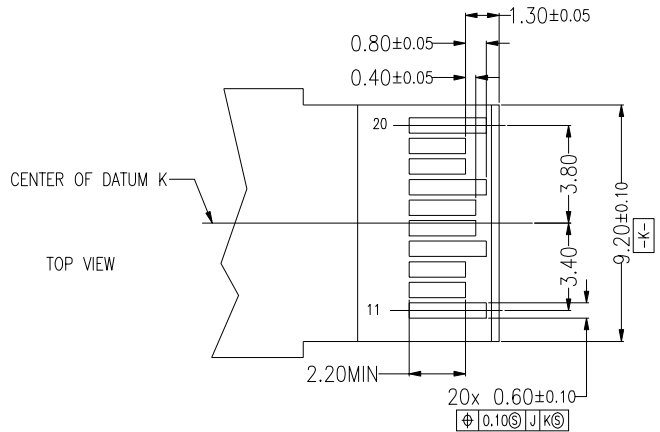

RECOMMENDED LAYOUT DETAIL MATING
TRANSCEIVER PCB

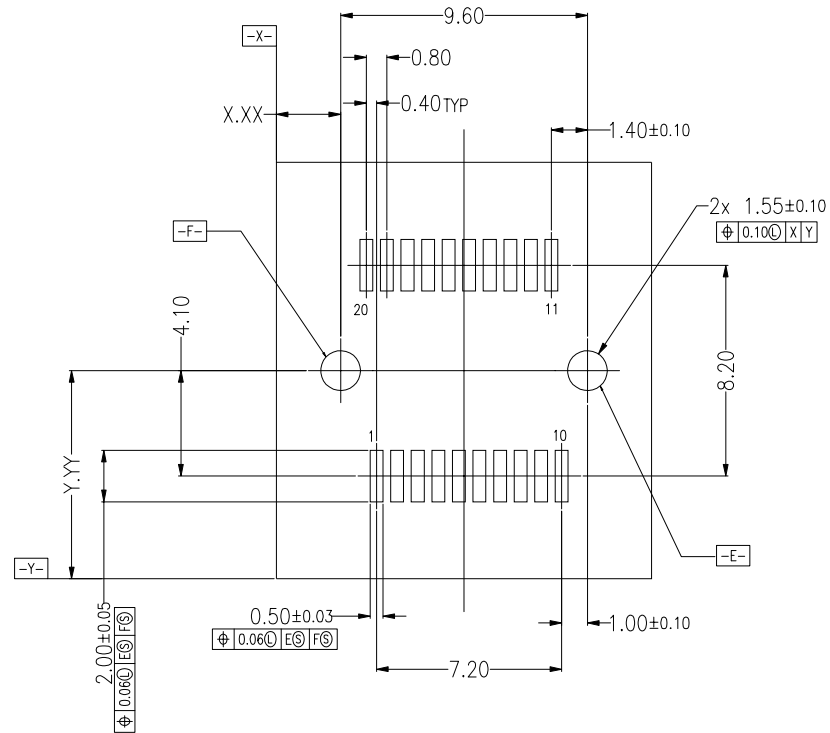

RECOMMENDED PCB LAYOUT

- NOTES:
1. GROUNDS ARE CLEARED UNDER SIGNAL PADS
2. BASIC DIMENSION X.XX TO BE ESTABLISHED

自由公差			设计		苏州沃虎电子科技有限公司 SUZHOU WOHU ELECTRONIC TECHNOLOGY CO.,LTD			
长度尺寸		角度尺寸	Shmily				2015.04.09	
X. ±0.30		X° ±0.5°	审核		GZW	品名	SFP 1x1 CONNECTOR	
.X ±0.30		.X° ±0.5°					2015.04.09	料号
.XX ±0.20		.XX° ±0.5°	核准		Neil	2015.04.09	图号	ESFP15020325-C
.XXX ±0.10							单位	mm
版次	修改说明		ECN 编号	核准	A4	页次	2 of 2	

1

2

3

4

5

6

7

8