

REV.	DESCRIPTION	NAME	DATE
A	NEWS ISSUE		

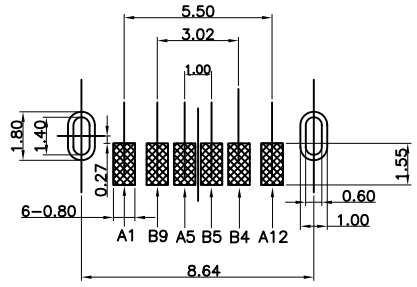

RECOMMENDED P.C.B. LAYOUT  
TOLERANCE UNSPECIFIED ±0.05mm

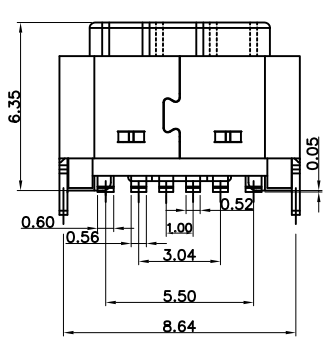
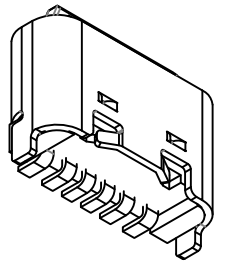
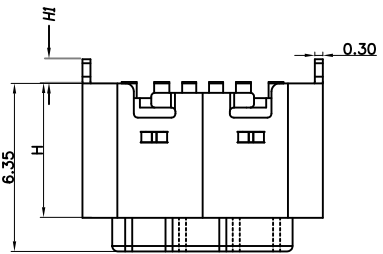
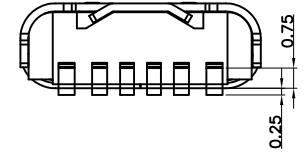
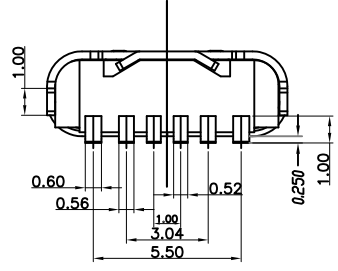
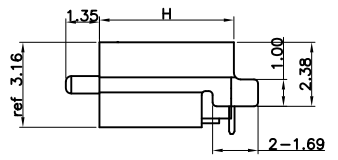
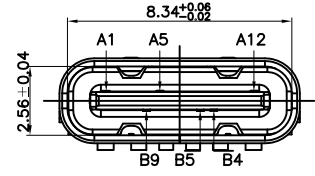

NOTE:

- MATERIAL SPECIFICATION:
  - HOUSING: HIGH TEMPERATURE RESISTANT PLASTIC, LCP UL94 V-0.
  - CONTACTS: COPPER ALLOY C2680
  - MID PLATE: STAINLESS STEEL SUS301
  - FRONT SHELL: STAINLESS STEEL SUS304
- PLATING SPECIFICATION:
  - CONTACTS:
    - Ni 50u" MIN. UNDER PLATED OVER ALL.
    - Au PLATED ON THE FUNCTIONAL AREA OF CONTACT. (GOLD PLATING THICKNESS FOLLOW)
    - PLATING SPECIFICATIONS OF THE SOLDER AREA FOLLOW
  - FRONT SHELL: SUS304.
  - SHIELD PLATE&EMI PLATE: CLEAR ONLY
- MECHANICAL PERFORMANCE,
  - INSERTION FORCE: 0.5~2.0kgf.
  - REMOVAL FORCE: 0.8kgf~2.0kgf.
  - DURABILITY: 10000 CYCLES.
- ELECTRICAL PERFORMANCE,
  - CURRENT RATING: 3.0A  
VOLTAGE RATING: 5.0V
  - LLCR:
    - VBUS & GND PINS AND OTHER PINS: 40mΩ/PIN MAX.
    - SHIELD: 50mΩ/MAX.
    - LLCR MAX. CHANGE OF ALL PINS: 10mΩ.
  - INSULATION RESISTANCE: 100MΩ MIN
  - DIELECTRIC WITHSTAND VOLTAGE, AC 100V FOR 1 MINUTE.
- ENVIRONMENTAL PERFORMANCE:
  - OPERATING TEMPERATURE: -25° C~+85° C.
  - IR REFLOW:
    - THE PEAK TEMPERATURE ON THE BOARD SHALL BE MAINTAINED FOR 10 SECONDS AT 260° C.

PIN ASSIGNMENTS

PIN	SIGNAL NAME	PIN	SIGNAL NAME
A1	GND	B9	VBUS
A5	CC1	B5	CC2
A12	GND	B4	VBUS

H1=0.9	H H =5.5
H1=1.5	H H =5.0

TOLERANCE UNSPECIFIED

.0	±0.35
.00	±0.25
.000	±0.15
X. °	±2.00°

CUSTOMER DRAWING

**WOHU** 苏州沃虎电子科技有限公司  
Tel:4001048018 <http://www.wohu-tek.com>

TITLE:  
TYPE-C 6P 母座 直立式 H=5.0 舌片外漏1.35 两脚插 端子SMT 带中夹片

DRAWN/ DATE	设计 TSP	SIZE:A4	UNIT:MM.	PART. NO:	UC.01.53-1B-0003
CHECKED/ DATE	LYX	SCALE: 1:1	PROJECTION	REV.:	版本
APPROVED/ DATE	LJP	DWG. PATH	0325-2	SHEET:	页码

REV.	DESCRIPTION	NAME	DATE
A	NEWS ISSUE		

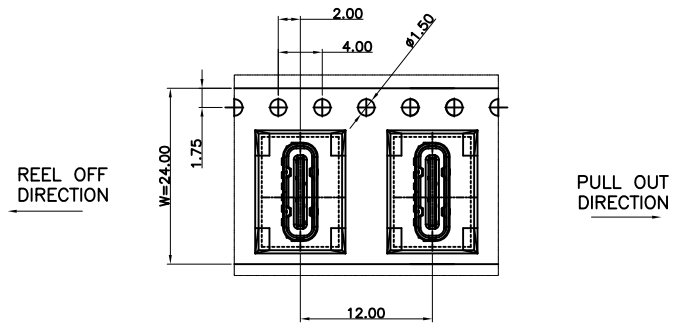
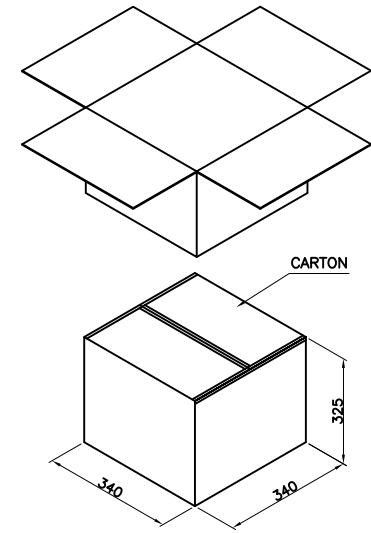
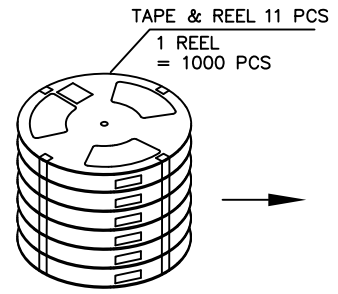
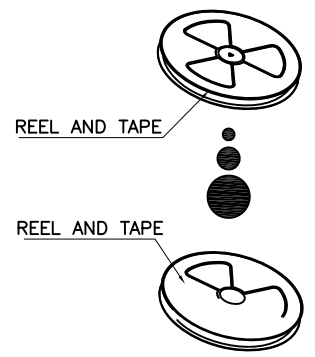
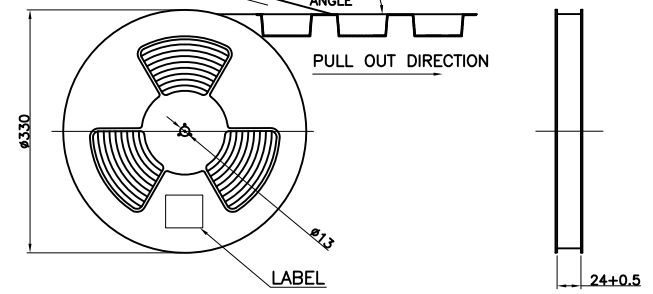
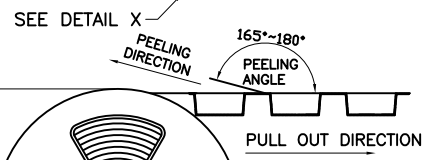
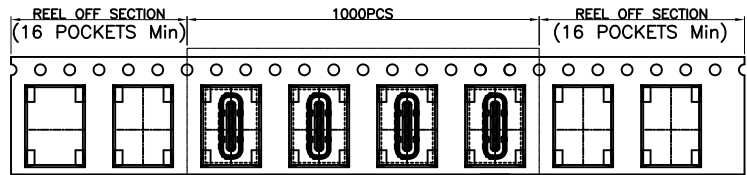

TOLERANCE UNSPECIFIED

.0	±0.35
.00	±0.25
.000	±0.15
X. °	±2.00°

CUSTOMER DRAWING

**WOHU** 苏州沃虎电子科技有限公司  
Tel:4001048018 <http://www.wohu-tek.com>

TITLE:  
TYPE-C 6P 母座 直立式 H=5.0 舌片外漏1.35 两脚插 端子SMT 带中夹片

DRAWN/ DATE	设计 TSP	SIZE:A4	UNIT:MM.	PART. NO:	UC.01.53-1B-0003
CHECKED/ DATE	LYX	SCALE: 1:1	PROJECTION	REV.:	版本
APPROVED/ DATE	LJP	DWG. PATH		0325-2	SHEET: 页码